

3M Science.
Applied to Life.™

3M™ Particulate Respirator 9542V, P2

Technical Data Sheet

The 9542V is a disposable specialty respirator with P2 rated filtration that offers protection against certain dusts, mists and fumes. The added carbon layer provides effective relief from nuisance levels* of organic vapours and odours. It is designed to fit a wide range of facial sizes. Its foldable design is portable and easy to carry. Each respirator is individually packaged, protecting it from contamination prior to use.

Features

- Provides protection against mechanically and thermally generated particulates
- 3M™ Cool Flow™ valve: effectively removes heat build-up and provides a cooler and more comfortable wear. The 3M Cool Flow valve also minimises the risk of fogging up eyewear
- Knitted headbands increases wearer comfort
- Disposable and maintenance free
- Lightweight construction promotes greater comfort and increased wear time
- Soft cover web on respirator's inner panel feels comfortable against the wearer's skin
- Added carbon layer provides relief from nuisance levels* of organic vapours and odours
- Adjustable noseclip helps with a custom fit and secure seal

Time Use Limitation

- If the respirator becomes damaged, soiled or breathing becomes difficult, leave the contaminated area and then replace and refit the respirator.
- This respirator contains a layer of activated charcoal to remove nuisance levels* of organic vapours and odours. However, if the respirator is worn and fitted correctly and you can smell or detect the contaminant, then replace the respirator as the capacity of the carbon has been exceeded.



Applications

This respirator is suitable for the following suggested applications (but is not limited to):

- Waste disposal and recycling facilities
- Foundry operations
- Printing
- Mining
- Solvent cleaning
- Light welding

Materials

The following materials are used in the production of this product:

Straps:	PET, Nylon, Elastane
Staples:	Steel
Nosefoam:	Polyurethane
Nose clip:	Aluminium
Filter:	Polypropylene / Carbon
Valve:	Polypropylene and Polyisoprene

This respirator does not contain components made from natural rubber latex or fibreglass.

Weight - 20g per respirator.

* Nuisance levels are those levels below the relevant Workplace Exposure Standards.

3M Personal Safety Division | 3M™ Particulate Respirator 9542V, P2

Warnings and Use Limitations

This product meets the performance requirements of AS/NZS 1716:2012.

P2 is the rating given to a respirator that meets AS/NZS1716:2012 for filtering mechanically and thermally generated particles, e.g. those from welding fume.

Respirators with a P2 rating are also recommended for use in certain applications against some pathogenic biological airborne particulates. A copy of AS/NZS 1716:2012 can be purchased from SAI Global.

1. Failure to follow all instructions and limitations on the use of this respirator and/or failure to wear this respirator during all times of exposure can reduce respirator effectiveness and **may result in sickness or death.**
2. It is recommended that a face fit test be conducted before assigning a respirator to an individual. If you cannot achieve a proper fit, do not enter contaminated area. See your supervisor.
3. Inspect respirator before each use to ensure it is in good working condition. Examine all the respirator parts for signs of damage including the two straps, noseclip, nose foam and staples. The respirator should be disposed of immediately upon observation of damaged or missing parts.
4. Leave the contaminated area immediately and contact supervisor if dizziness, irritation or other distress occurs.
5. Dispose of used product in accordance with applicable regulations.
6. All respirators should be used in accordance with local regulations.
7. Do not alter, wash, abuse or misuse this respirator.
8. Do not use with beards or other facial hair or other conditions that prevent a good seal between the face and the sealing edge of the respirator.
9. This respirator can help protect the wearer's lungs against certain airborne contaminants; however, it will not prevent entry through other routes such as the skin or eyes, which would require additional personal protective equipment (PPE).
10. This respirator is designed for occupational/professional use by adults who are properly trained in their use and limitations. This respirator is not designed to be used by children.
11. Individuals with a compromised respiratory system, such as asthma or emphysema, should consult a physician and complete a medical evaluation prior to use.
12. Maximum Operating Temperature: + 50 degrees Celsius.
13. The filtration efficiency of this respirator may decrease in the presence of oily mists.
14. This product does not contain components made from natural rubber latex.

Storage Conditions and Shelf Life

Shelf life of unopened product is three (3) years from date of manufacture when stored within

temperature range of -20°C to +30°C and at less than 80% relative humidity.

It is recommended that wearers be fit tested in accordance with the AS/NZS 1715:2009 Standard. For information regarding fit testing procedures, contact 3M.

Fitting Instructions

Must be followed each time the respirator is worn. Before fitting device, ensure hands are clean.

See Figure 1.

1. Cup respirator in hand, fingertips positioned at nosepiece and straps hanging below the hand.
2. Place the respirator against your face with the nosepiece across the bridge of your nose. Hold the respirator on your face and position it under the chin.
3. Pull the top strap over your head resting it high at the top of your head. Pull the bottom strap over your head then position it around your neck and below your ear.
4. Place the fingertips of both hands at the top of the metal nosepiece. Mould the nosepiece to the shape of the nose bridge by pushing inwards while moving your finger tips down both sides of the nosepiece.

Note: Pinching the respirator nosepiece using only one hand may result in less effective respirator fit. Use two hands.

Figure 1

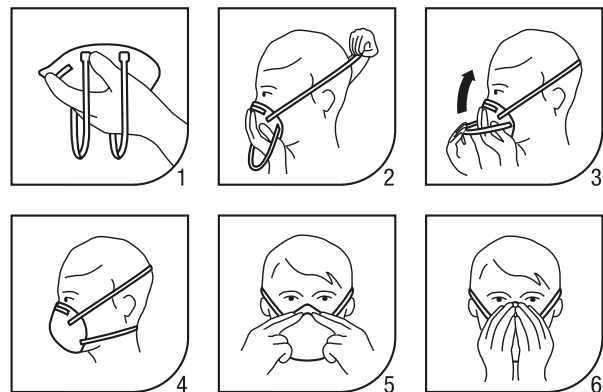

3M Personal Safety Division | 3M™ Particulate Respirator 9542V, P2

Fit Check

1. Cover the front of the respirator with both hands being careful not to disturb the fit of the respirator.
2. (a) UNVALVED respirator - EXHALE sharply;
(b) VALVED respirator - INHALE sharply.
3. If air leaks around the nose, re-adjust the nose clip to eliminate leakage. Repeat the above fit check.
4. If air leaks at the respirator edges, work the straps back along the sides of the head to eliminate leakage. Repeat the above fit check.

If you CANNOT achieve a proper fit DO NOT enter the hazardous area. See your supervisor.

It is recommended that wearers be fit tested in accordance with AS/NZS 1715:2009 Standard. For information regarding fit testing procedures, please contact 3M.

Removal Instructions

See Step 3 of Fitting Instructions and place hand over the respirator to maintain position on the face. Pull the bottom strap over the head. Still holding respirator in position, pull the top strap over your head and remove the respirator.

Warning: Respirators must not be used until your employer has determined whether usage will be in accordance with manufacturer's instructions. The wearer must be trained in the proper fitting and use of this product. Failure to follow all instructions and warnings on the use of this product and/or failure to wear this respirator during all times of exposure can reduce respirator effectiveness and result in illness or death. All respirators should be used in accordance with Australian standard AS/NZS 1715. It is recommended that fit testing be conducted before assigning a respirator to an individual. If you cannot achieve a proper fit, do not enter contaminated areas. Do not use with beards or other facial hair or conditions that prevent a good seal between the face and the sealing surface of the respirator.

Important Notice: To the extent permitted by law, 3M shall not be liable for any loss or damage including any loss of business, loss of profits, or for any indirect, special, incidental or consequential loss or damage arising from reliance upon any information herein provided by 3M. Nothing in this statement will be deemed to exclude or restrict 3M's liability for death or personal injury arising from its negligence.



3M Australia Pty Ltd
Personal Safety Division
 Bldg A, 1 Rivett Road
 North Ryde NSW 2113

TechAssist Helpline 1800 024 464
 Customer Service 1300 363 565
 Email techassist@mmm.com
 Web www.3M.com.au/ppesafety

3M New Zealand Ltd
Personal Safety Division
 94 Apollo Drive, Rosedale
 Auckland 0632

TechAssist Helpline 0800 364 357
 Customer Service 0800 252 627
 Email 3mnzitb@mmm.com
 Web www.3m.com.nz/ppesafety

3M is a trademark of 3M.
 © 3M 2019. All rights reserved.
 AV